

BLOOM TOWNSHIP SECTION 9 R12 TWP 11 MORGAN COUNTY, OH

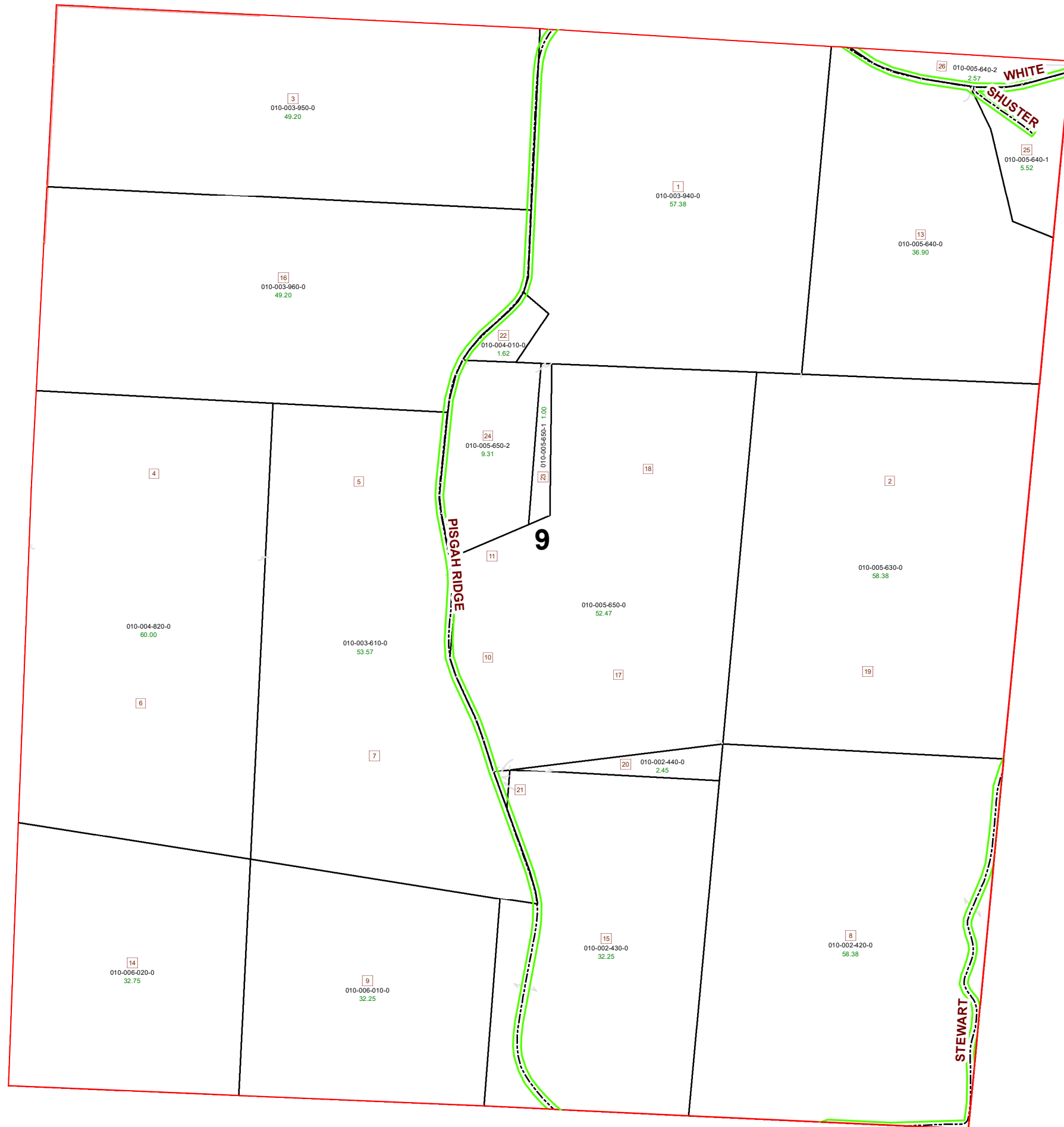

PIN	VOL	PAGE	Owner	LegalDescr	Acres
010-006-010-0	OR185	534	HOPKINS STANLEY L & ELIZABETH A	R12 T11 S09 SD 9	32.25
010-006-020-0	OR185	534	HOPKINS STANLEY L & ELIZABETH A	R12 T11 S09 SD 1A	32.75
010-002-440-0	OR205	730	HOPKINS STANLEY L & ELIZABETH ANN	R12 T11 S09 SD 20-	2.45
010-002-430-0	OR205	730	HOPKINS STANLEY L & ELIZABETH ANN	R12 T11 S09 SD 15	32.25
010-002-420-0	OR205	730	HOPKINS STANLEY L & ELIZABETH ANN	R12 T11 S09 SD 8 S	58.38
010-003-610-0	OR138	467	MCDANIEL WILLIAM L & MARTHA M	R12 T11 S09 SD 5-7	53.57
010-004-820-0	OR184	594	MOORE DANNY W & ELIZABETH A	R12 T11 S09 SD 4-6	60
010-004-010-0	OR134	421	MOORE RONALD & MARJORIE L	R12 T11 S09 SD 22	1.62
010-003-960-0	OR116	489	MOORE RONALD L & DANNY W	R12 T11 S09 SD 16	49.2
010-003-940-0	OR116	489	MOORE RONALD L & DANNY W	R12 T11 S09 SD 1	57.38
010-003-950-0	OR116	489	MOORE RONALD L & DANNY W	R12 T11 S09 SD 3	49.2
010-005-640-1	OR205	1568	SHUSTER BILLIE J	R12 T11 S09 SD 25	5.521
010-005-640-2	OR205	1578	SHUSTER BILLIE J	R12 T11 S09 SD 26	2.575
010-005-630-0	OR181	779	SHUSTER DONALD M	R12 T11 S09 SD 2-1	58.38
010-005-640-0	OR181	779	SHUSTER DONALD M	R12 T11 S09 SD 13	36.904
010-005-650-0	OR26	672	SHUSTER ROY S	R12 T11 S09 SD 10-	52.474
010-005-650-1	OR200	413	SHUSTER ROY S	R12 T11 S09 SD 23	1.006
010-005-650-2	OR200	413	SHUSTER ROY S	R12 T11 S09 SD 24	9.316

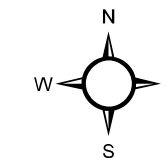

Boundaries	
	Lot
	ROW
	Section
	Roads
	Township
	County
	Hidden
	Symbols
	Roads
	Sections
	Parcels

